

Roll-Around Shop Cart

Materials

Cart

A Stiles (4)	$1\frac{1}{2} \times 3\frac{1}{2} - 23$
B Center/Bottom Rails (4)	$1\frac{1}{2} \times 3\frac{1}{2} - 22$
C Upper Rails (2)	$1\frac{1}{2} \times 1\frac{1}{2} - 22$
D Side Panels (2)	$7\frac{1}{2} \times 22 - \frac{3}{4}$ MDF
E Filler Strips (4)	$1\frac{1}{2} \times \frac{3}{4} - 8$
F Shelf/Bottom Panel (2)	$19 \times 26\frac{1}{2} - \frac{3}{4}$ MDF
G Edging	$\frac{3}{4} \times \frac{3}{4} - 25$ Ln. Ft.
H Divider (1)	$12\frac{3}{4} \times 19\frac{3}{4} - \frac{3}{4}$ MDF
I Top (1)	$22 \times 30\frac{1}{2} - \frac{3}{4}$ MDF
J Cleats (3)	$1\frac{1}{2} \times 1\frac{1}{2} - 19$
K Caster Plates (2)	$\frac{3}{4} \times 3\frac{1}{2} - 22$

Drawers

L Small Drawer Front/Back (2)	$\frac{1}{2} \times 3\frac{1}{2} - 17\frac{1}{2}$
M Small Drawer Sides (2)	$\frac{1}{2} \times 3\frac{1}{2} - 20$
N Large Drawer Front/Back (2)	$\frac{1}{2} \times 7\frac{1}{2} - 17\frac{1}{2}$
O Large Drawer Sides (2)	$\frac{1}{2} \times 7\frac{1}{2} - 20$
P Drawer Bottoms (2)	$17\frac{1}{2} \times 19\frac{1}{2} - \frac{1}{4}$ Ply.
Q Spacers (2)	$\frac{3}{8} \times 1\frac{1}{4} - 17\frac{1}{8}$
R Small Drawer False Front (1)	$\frac{3}{4} \times 4\frac{3}{16} - 19\frac{1}{2}$
S Large Drawer False Front (1)	$\frac{3}{4} \times 8\frac{3}{16} - 19\frac{1}{2}$
T Cubby Front (1)	$\frac{3}{4} \times 3\frac{1}{8} - 19\frac{3}{4}$

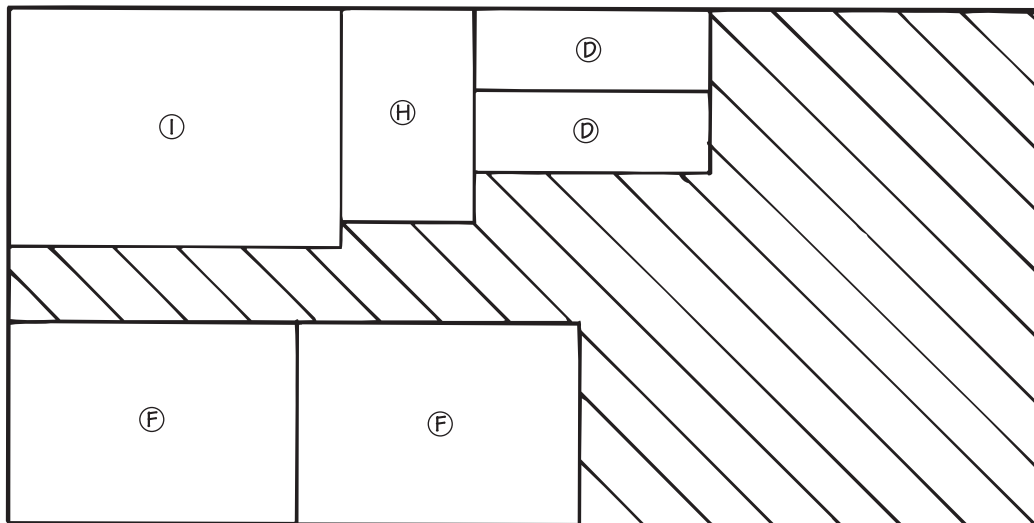

49" x 97" - $\frac{3}{4}$ " MDF

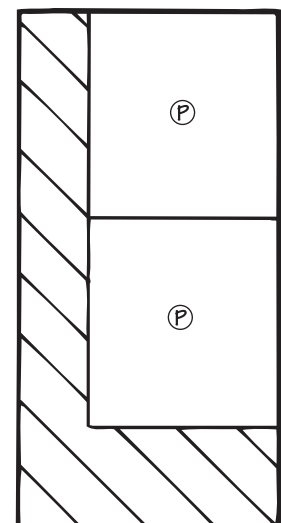

24" x 48" - $\frac{1}{4}$ " PLYWOOD

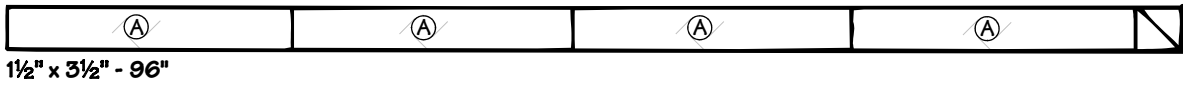

1 1/2" x 3 1/2" - 96"

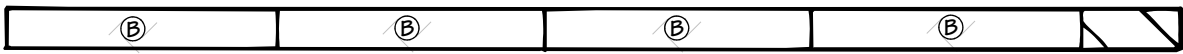

1 1/2" x 3 1/2" - 96"

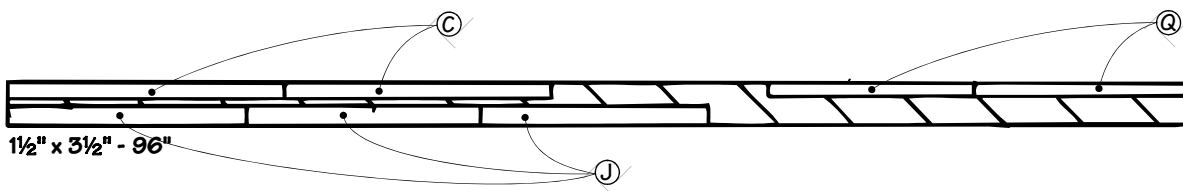

1 1/2" x 3 1/2" - 96"

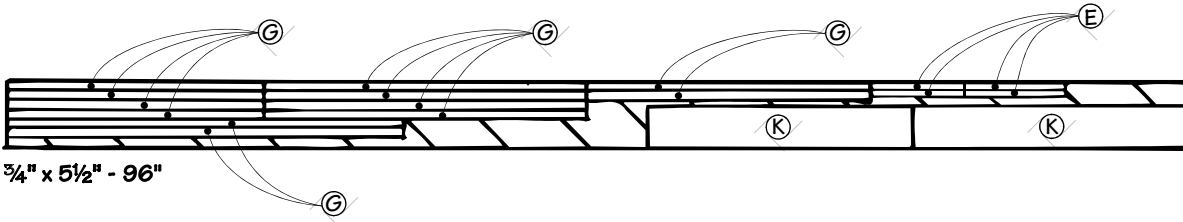

3/4" x 5 1/2" - 96"



3/4" x 5 1/2" - 96"



1/2" x 5 1/2" - 96"



1/2" x 5 1/2" - 96" (2 Boards)