

# Sanding Station

## Materials List

A	Sides (2)	23 x 30 - 3/4" MDF	L	Drawer Sides (4)	7 x 21 - 1/2" Ply.
B	Shelf/Bottom (2)	22 1/2 x 45 - 3/4" MDF	M	Drawer Bottoms (2)	20 1/2 x 20 3/8 - 1/4" Hdbd.
C	Drawer Divider (1)	7 3/4 x 22 1/2 - 3/4" MDF	N	Drawer False Frts. (2)	7 5/8 x 21 3/4 - 3/4" MDF
D	Back Panel (1)	30 x 45 - 1/2" MDF			
E	Caster Plates (2)	4 x 23 - 3/4" MDF			
F	Baffles (2)	22 x 25 15/16 - 1/2" MDF			
G	Front Panel (1)	20 3/4 x 44 1/2 - 1/2" MDF			
H	Panel Supports (7)	3/4 x 1 1/2 - 22			
I	Top Trim	1 1/2 x 2 - 156 Rgh.			
J	Grates/Solid Panels (8)	5 3/4 x 23 - 3/4" MDF			
K	Drawer Fronts/Backs (4)	7 x 20 3/8 - 1/2" Ply.			

- (2 pr.) 5" Locking Swivel Casters
- (16) #12 x 1 1/4" Ph Screws
- (14) #8 x 1 1/2" Fh Woodscrews
- (2 pr.) 20" Full-Extension Drawer Slides w/Screws
- (2) 4" Drawer Pulls w/Screws
- (8) #8 x 1" Fh Woodscrews

## Cutting Diagram

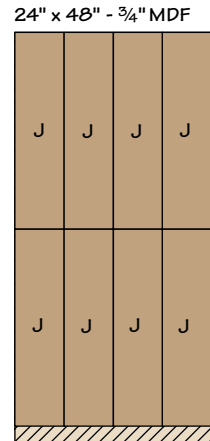
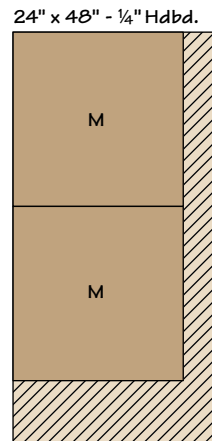
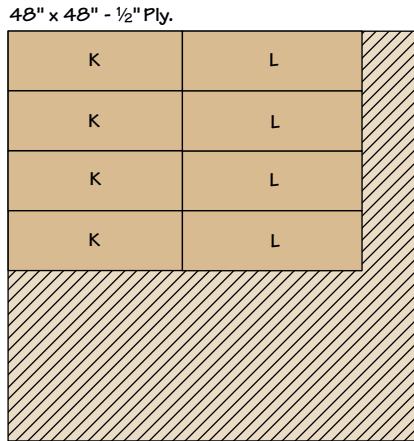
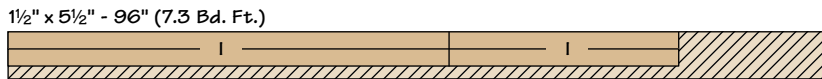

# Cutting Diagram (continued)

---

48" x 96" - 3/4" MDF

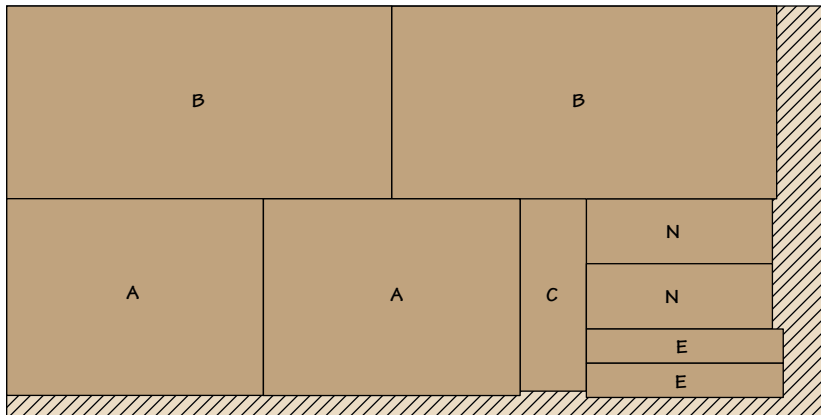

48" x 96" - 1/2" MDF

